

8-port 10/100M Desktop PoE Switch TL-SF1008P



With four PoE ports,
transfers data and power
on one single cable

Working with IEEE 802.3af
compliant PDs, expands
home and office network

Requires no configuration
and installation

Description:

TL-SF1008P is an 8 10/100M ports unmanaged switch that requires no configuration and provides 4 PoE (Power over Ethernet) ports. It can automatically detect and supply power with all IEEE 802.3af compliant Powered Devices (PDs). In this situation, the electrical power is transmitted along with data in one single cable allowing you to expand your network to where there are no power lines or outlets, where you wish to fix devices such as APs, IP Cameras or IP Phones, etc.

TL-SF1008P has the priority function which will help protect the system by cutting off the power of the lowest-priority port when the system power is overloaded.

Specifications:

Standards	IEEE802.3, IEEE802.3u, IEEE802.3x, IEEE802.3af
Interfaces	8 10/100M Auto-Negotiation RJ45 ports with 4 PoE ports (port-1 to port-4)
Network Media(Cable)	10Base-T: UTP category 3, 4, 5 cable (maximum 100m) EIA/TIA-568 100Ω STP (maximum 100m)
	100Base-TX: UTP category 5, 5e cable (maximum 100m) EIA/TIA-568 100Ω STP (maximum 100m)
Transfer Method	Store-and-Forward
MAC Address Table	1K
MAC Address Learning	Automatically learning, automatically aging
Data Transfer Rate	Ethernet: 10Mbps (Half Duplex), 20Mbps (Full Duplex) Fast Ethernet: 100Mbps (Half Duplex), 200Mbps (Full Duplex)
Frame Forward Rate	10Base-T: 14880pps/Port 100Base-Tx: 148800pps/Port
PoE Power on RJ45	Power+: pin 3 & pin 6 Power -: pin 1 & pin 2
Power Supply	Input: External power adapter Output: 48VDC
Power Consumption	5.8 watts. (max. no PD connected) 58 watts (max. with 53w PD connected)
LEDs	Power, Link/Act, 100Mbps, PoE Status
Certifications	CE, FCC
Operating Temperature	0°C ~ 40°C (32°F ~ 104°F)
Storage Temperature	-40°C ~ 70°C (-40°F ~ 158°F)
Operating Humidity	10% ~ 90% RH non-condensing
Storage Humidity	5% ~ 90% RH non-condensing
Dimensions(L x W x H)	6.7x3.9x1.1in.(171x98x27mm)

Diagram:

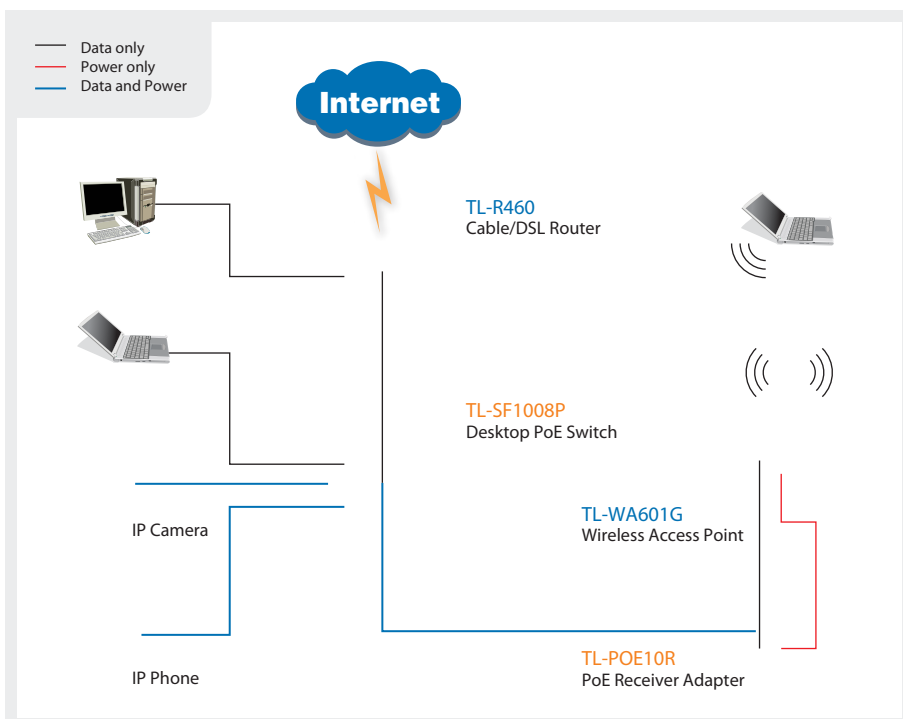

Features:

- Complies with IEEE802.3, IEEE802.3u, IEEE802.3af standards
- 1K entry MAC address table of the TL-SF1008P with auto-learning and auto-aging
- 8 10/100Mbps Auto-Negotiation RJ45 ports with 4-port PoE function (port-1 to port-4), all of them support Auto MDI/MDIX
- Supports PoE power up to 15.4W for each PoE port
- Supports PoE power up to 53W for all PoE ports
- Supports PoE IEEE 802.3af compliant PDs
- Supports IEEE802.3x flow control for Full-duplex Mode and backpressure for Half-duplex Mode
- Supports priority function to protect the system when the system power is overloaded
- LED indicators for monitoring power, link, activity and speed
- External power adapter supply

Package:

- 8-port 10/100M Desktop PoE Switch TL-SF1008P
- User Guide
- DC Power Adapter

Related Products:

- 24+4G Gigabit-Uplink Web Smart Switch TL-SL2428WEB
- Cable/DSL Router TL-R460
- PoE Receiver Adapter TL-POE10R
- 108M Wireless Access Point TL-WA601G
- 10/100M PCI Network Adapter TF-3239DL

Specifications are subject to change without notice. is a registered trademark of TP-LINK Technologies Co., Ltd. Other brands and product names are trademarks or registered trademarks of their respective holders. No part of the specifications may be reproduced in any form or by any means or used to make any derivative such as translation, transformation, or adaptation without permission from TP-LINK Technologies Co., Ltd.